

R2100DG

4" Series

Square Regressed Double Gimbal Trim

Project	
Notes	
Fixture Type	
Date	

SPECIFICATIONS

TRIM	Powder coat painted or plated die-formed steel. Different finishes available. Painted finishes available with Marine Grade option.
LAMPS (maximum wattage)	MR16 GU 5.3 50W For MR16 LED lamp usage, please refer to the selected housing specification sheet (see compatible housing list below). *Use supplied glass lens only with un protected MR16 lamps.
LENS	Standard: Clear Lens Available: Frosted Lens
REFLECTORS	Standard: Black paint Available: White (-01) Matte White (-11) White (W) - For White and Matte White Trims add W to code
CEILING CUTOUT	Ø 4-1/4" (108 mm)
CERTIFICATION	cULus E174023 for damp locations
WARRANTY	1 year for standard finishes, 2 years on "Marine Grade" finishes.



R2100DG-12BR
(illustrated)

Tilting Axis 1

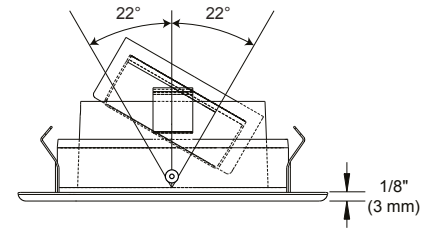

Tilting Axis 2

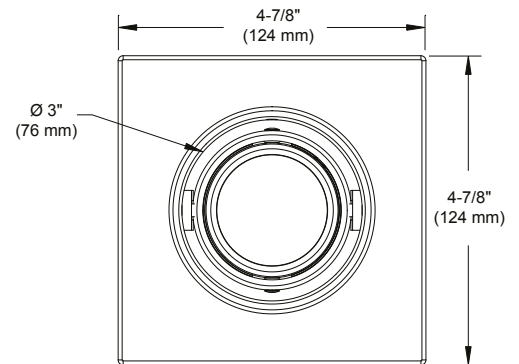
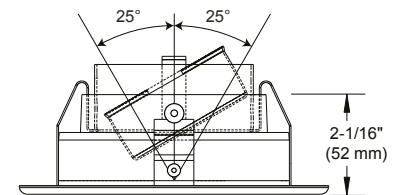

COMPATIBLE HOUSINGS

	Remodel Housing	New Construction Housing	Insulated Housing
HALOGENS	MR16 GU 5.3 50W IT2000E IT2000M	MR16 GU 5.3 50W NW2000E NW2000LM	MR16 GU 5.3 50W ISMR2000M



CONTRASTE

2018-01
Revision 1

PRINTED IN CANADA

1009, rue du Parc Industriel
Lévis (Québec) G6Z 1C5 Canada
Tel.: 1-888-839-4624
Fax.: 1-877-839-7057
contrastelighting.com
info@contrastelighting.com

© 2018 Contraste Lighting M.L. Inc.
All rights reserved

Contrast Lighting M.L. Inc. reserves the right to make changes in specifications and/or to discontinue any product at any time without notice or obligation and will not be liable for any consequences resulting from the use of this publication.

R2100DG

4" Series

CODIFICATION EXAMPLE

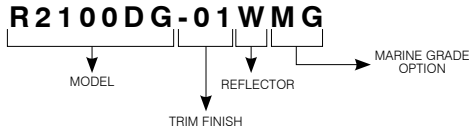

ORDERING CODES

MODEL	TRIM FINISHES	REFLECTORS	MARINE GRADE
R2100DG			
R2100DG	<ul style="list-style-type: none"> -01 White -02 Black -03 24K Gold Plated -04 Chrome -04BR Brushed Chrome -05 Architectural Bronze -06 Antique Copper -11 Matte White -12BR Brushed Nickel -13 Satin Nickel -15 Metallic Grey 	<ul style="list-style-type: none"> Standard: Black paint -01 White -11 Matte White W For White (-01) and Matte White (-11) Trim add W to code 	<ul style="list-style-type: none"> MG (optional) May be applied on finishes: -01, -02, -05, -06, -11 and -15

MARINE GRADE

2-year warranty on finish

This option increases the painted finishes resistance by reducing and delaying apparition and propagation of oxidation (ex: rust and others).

MARINE GRADE treatment is recommended for damp to wet locations.

Unless otherwise indicated, trims are for interior use. Also suitable for cold and exterior locations, as in soffits, where fixtures are not subject to direct rain or snow exposure.

WARNING – This option is not suitable for salt environments and/or highly corrosive areas such as soffits in coastal regions and natatoriums. Such usage would void warranty on the product.

