

IT3000CE

3 1/2" 3000 Series

Project _____
 Notes _____
 Fixture Type _____
 Date _____

Shallow Remodel Housing with Electronic Converter

SPECIFICATIONS

HOUSING DETAILS Up to 18 gauge or 0,051" (1,3 mm) thick galvanized steel housing.
 Junction box can support up to 10 – 14 gauge wires or 8 – 12 gauge wires.
 Below-ceiling accessible.

MOUNTING **Cutout diameter:** \varnothing 3 5/8" (92 mm)
 Can fit in ceilings up to 7/8" (22 mm) thick.
 Requires a 3 7/8" (98 mm) clearance beyond the ceiling level.
 Patented hook (PAT#CAN 2,088,648 and #USA 5,377,088) for ease of installation and a perfect fit to ceiling.
 No light leakage.

LAMP **MR16 37W MAX**
 This product was designed for MR16 halogen lamps. If you want to use the dimming option and you replace the MR16 lamp by an equivalent LED lamp, please see dimmer compatibility list on our Website.

VOLTAGE IT3000CE: 120 VOLTS (CAN & USA)
 IT3000CE2: 277 VOLTS (USA)

ELECTRONIC CONVERTER **Electronic Converter**
 IT3000CE 120V / 12V
 IT3000CE2 277V / 12V

COMPATIBLE TRIMS	35W MR16			37W MR16	
	T3000 T3125 T3200	T3250 T3260 T3300	T3400D T3450D T3500D	R3450D R3470 R3470D T3145DG T3250DG	

CERTIFICATION cULus **E174023** for damp locations

WARRANTY 3 year warranty on converter and 5 years on the socket.

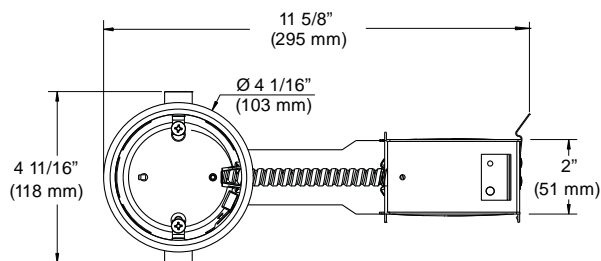
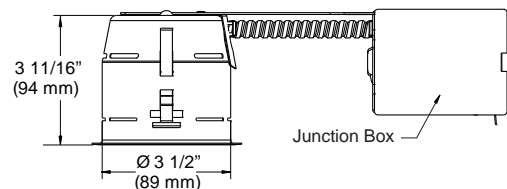
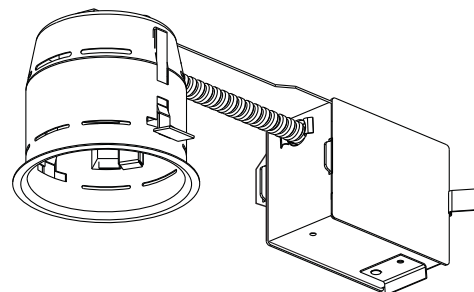

CODIFICATION EXAMPLE

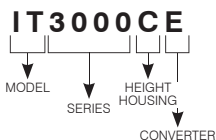

ORDERING CODE

MODEL	SERIES	HEIGHT HOUSING	CONVERTER	VOLTAGE
IT	3000	C	E	
IT Remodel	3000 3 1/2" Series	C Short Housing	E Electronic (120/277V)	... 120 Volts 2 277 Volts

