

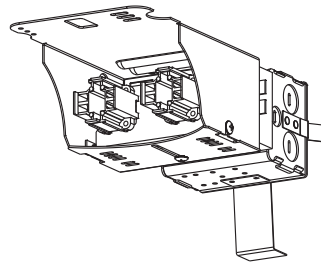







# SPECIFICATION SHEET

## 6" COMPACT FLUORESCENT SERIES

# F6H

### REMODEL HOUSING FOR HORIZONTAL LAMP



	<b>YES</b>									
<b>Damp location</b>										
	<b>ÉLECTRONIC BALLAST</b>									
<b>Electronic ballast</b>										
	<b>120 VOLTS</b> (CAN & USA.) <b>277 VOLTS</b> (USA.) <b>347 VOLTS</b> (CANADA)									
<b>Voltage</b>										
	<b>13W to 32W</b>	<table border="0"> <tr> <td>13W : G24q-1</td> <td>4 PIN DTT</td> </tr> <tr> <td>18W : G24q-2</td> <td>4 PIN DTT</td> </tr> <tr> <td>26W : G24q-3</td> <td>4 PIN DTT</td> </tr> <tr> <td>32W : GX24q-3</td> <td>4 PIN TTT</td> </tr> </table>	13W : G24q-1	4 PIN DTT	18W : G24q-2	4 PIN DTT	26W : G24q-3	4 PIN DTT	32W : GX24q-3	4 PIN TTT
13W : G24q-1	4 PIN DTT									
18W : G24q-2	4 PIN DTT									
26W : G24q-3	4 PIN DTT									
32W : GX24q-3	4 PIN TTT									
<b>Compact Fluorescent</b>										
	<b>6 3/4" (171mm)</b>									
<b>OD Cut</b>										
	<b>Housing and trim assembly overall dimensions:</b> Height : 7 3/16" (183mm) Length : 13 3/8" (340mm) Width : 7 3/8" (187mm)									
<b>Dimensions</b>										

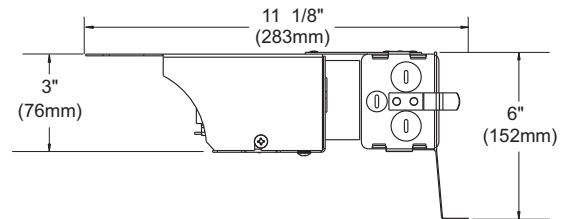

#### CODES :

F6H <u>U</u> 13	2 X 13W	120 to 277 Volts <u>U</u> niversal Ballast
F6H <u>U</u> 18	2 X 18W	
F6H <u>U</u> 26	2 X 26W	
F6H <u>U</u> 13S	1 X 13W	
F6H <u>U</u> 18S	1 X 18W	
F6H <u>U</u> 26S	1 X 26W	
F6H <u>U</u> 32S	1 X 32W	
F6H <u>3</u> 13	2 X 13W	347 Volts Ballast for Canada only
F6H <u>3</u> 18	2 X 18W	
F6H <u>3</u> 26	2 X 26W	
F6H <u>3</u> 13S	1 X 13W	
F6H <u>3</u> 18S	1 X 18W	
F6H <u>3</u> 26S	1 X 26W	
F6H <u>3</u> 32S	1 X 32W	
F6H <u>D</u> 18	2 X 18W	120 Volts <u>D</u> immable Ballast
F6H <u>D</u> 26	2 X 26W	
F6H <u>D</u> 18S	1 X 18W	
F6H <u>D</u> 26S	1 X 26W	
F6H <u>D</u> 32S	1 X 32W	
F6H <u>D</u> 18 <u>2</u>	2 X 18W	
F6H <u>D</u> 26 <u>2</u>	2 X 26W	
F6H <u>D</u> 18 <u>2</u>	1 X 18W	
F6H <u>D</u> 26 <u>2</u>	1 X 26W	
F6H <u>D</u> 32 <u>2</u>	1 X 32W	

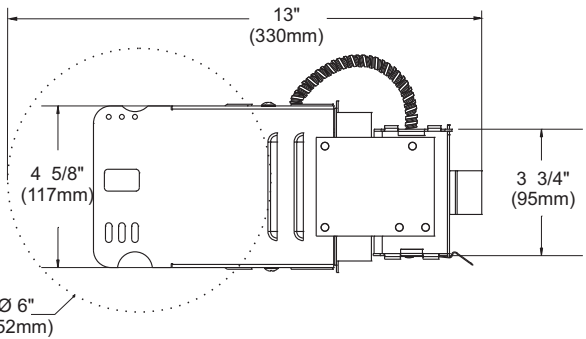

#### COMPATIBLE TRIMS

FR6HO	FR6HOLB	FR6HOMW120	FR6HOW120
FR6HOLA	FR6HOM	FR6HOMW90	FR6HOW90



 **ENERGY STAR® Requirements**  
**120 Volt ONLY**

- Lamp with a rated life of 10 000 hours or more, in these colors : 2700K, 3000K, 3500K or 4100K.  
Generic lamp designation :  
CFQ13W/G24q      CFQ26W/G24q  
CFQ18W/G24q      CFTR26W/GX24q  
CFTR18W/GX24q      CFTR32W/GX24q
- Combine housing with one of the following trims :  
FR6HO      FR6HOMW120  
FR6HOLA      FR6HOMW90  
FR6HOLB      FR6HOW120  
FR6HOM      FR6HOW90

#### TECHNICAL SPECIFICATIONS

<p><b>HOUSING FEATURES</b> Galvanized steel. Preset socket assembly and keyhole on socket assembly for easier installation. Below-ceiling accessible.</p> <p><b>LISTINGS</b> UL-cUL listed for through branch wiring and damp location.</p>	<p><b>LOCKING SYSTEM</b> Perfect fit into ceiling. No light leak. Hooks PAT#CAN.2.088.648 and #USA.5.377.088 Takes up to 7/8" thick ceiling.</p> <p><b>SOCKET</b> High temperature-rated. 130°C instead of 90°C. Stainless steel contacts.</p>	<p><b>BALLAST</b> 120V/277V Class P HPF Electronic ballast. <b>347V HPF Electronic ballast, available in Canada. For ordering change U to 3.</b> Ex : F6V313 Program start without flickering 10% THD and end of life lamp protection. 5 years warranty.</p>	<p><b>DIMMING CAPABILITY 18W +</b> When ordering a dedicated dimmable ballast, in product codes change «U» to «D» on 120V. Ex : F6VD26 For 277V dimmable, change «U» to «D» and add suffix «2». Ex : F6VD262 Ballast type : Advance Mark X. N.B. Dimmable ballast are dedicated to either 120 or 277V.</p>	<p><b>VOLTAGE</b> The 120V line is available either in Canada and USA. The 277V line is available only in the USA. The 347V line is available only in Canada.</p>
---	--	--	--	---